



Born and raised on the lap of Thrissur, not many builders could capture the pulse of a Thrissurite better than Vishraam. With a legacy spanning over a decade and a string of impressive residential projects, Vishraam has always been synonymous with perfection and trust. The brand has never restricted itself to just delivering dream abodes, rather it takes things further by establishing an everlasting relation with each of its customer, making them one of the very few builders with the best after sale service.

Today the name Vishraam stays highlighted among the most trusted builders in Kerala and continues to deliver services with utmost dedication and commitment.









Civaanta assures luxury living along with utmost privacy by providing completely independent apartment designs with no common walls. This ensures ample ventilation and natural lighting.

The project is also equipped with superior amenities making sure that luxury is a part of your lifestyle. Designed with utmost perfection to make you fall in love with your living space each time you step in.

Apart from assuaging your senses with the long list of plush amenities, also relish the boons of living at the heart of the city. Close to Thrissur city's hotspots, accessibility is another key feature Civaanta can offer you

Experience Thrissur at it's best by owning your own share of private luxury at Vishraam Builder's Civaanta.



CIVAANTA A Vishraam Project



## Typical Floor Plan

First to Ninth Floor

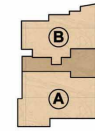

## TYPE A First Floor

Area : 1803 sq.ft. + 132 sq.ft. Garden



## TYPE A Second, Fourth & Sixth Floor

Area : 1684 sq.ft. + 95 sq.ft. Garden





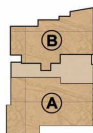

## TYPE A Third & Fifth Floor

Area : 1684 sq.ft. + 134 sq.ft. Garden



## TYPE A Seventh Floor

Area : 1684 sq.ft. + 74 sq.ft. Garden

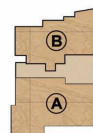

## TYPE A Eighth Floor

Area : 1684 sq.ft. + 158 sq.ft. Garden



## TYPE A Ninth Floor

Area : 1683 sq.ft.





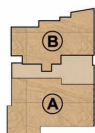

## TYPE B First to Seventh Floor

Area : 1491 sq.ft.

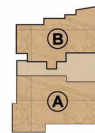

## TYPE B Ninth Floor

Area : 1423 sq.ft.



## TYPE B Eighth Floor

Area : 1476 sq.ft.



Every apartment is designed with precision and assures to provide maximum space, cross ventilation and natural light passage. Built around your needs, Civaanta is definitely the perfect blend of art and architecture.



## Tenth Floor Plan



## Eleventh Floor Plan







Ground Floor Plan

CIVAANTA A Vishraam Project

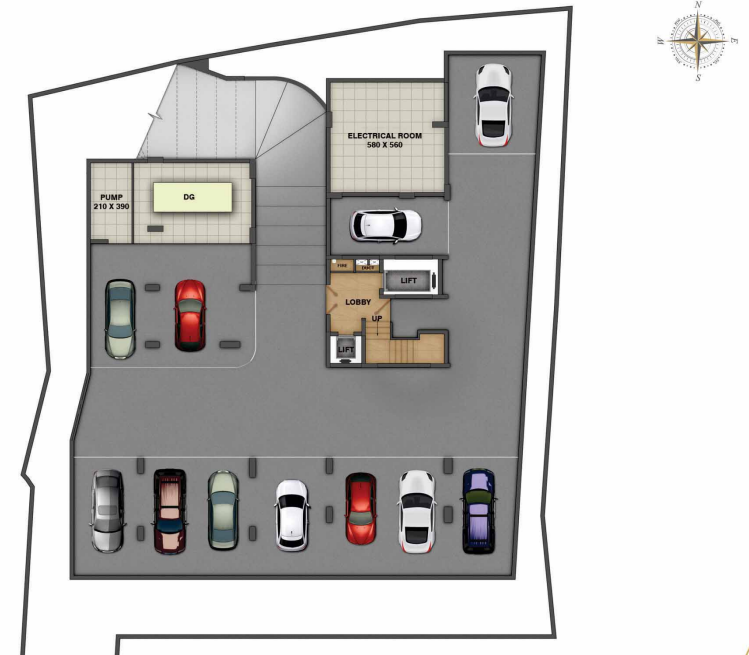

Basement Floor Plan



Location Map





/ Location Map

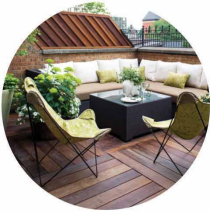

#### Terrace Patio and Garden

within and beyond. Step out to the wide patios and enjoy the greens in a higher plane. Relish the privileges of green and spacious living.



#### No common walls

Privacy at its best. No apartments share any common walls. Your space is just yours. It provides ample ventilation and lighting.



#### Air conditioned fitness studio

Offering you the most hygienic workout area. Good health starts from clean living.



#### Exclusive recreation floor

Share your happiness with more friends and relatives. Completely private multipurpose area with ample space and facilities.



#### Indoor games area

Climate is not a threat anymore, keep playing. That is why we have designed an indoor games area just for you.



#### Designated cloth drying area

There is a space for everything. An area is dedicated exclusively for drying clothes.



#### Controlled entry access

No home is complete without security. Peace of mind is guaranteed with zero security breach.



#### Total security features

Whole compound is closely monitored with high-end CCTV equipments. So that no corners are spared when it comes to safety.



#### Effectual water management

Uninterrupted water supply is unequivocally a luxury. Civaanta is equipped with water supply from well, bore well and corporation, with advanced water softening treatment plants.



#### Designer lift with ARD

Being a luxury apartment, art is an integral part of the project. The beautifully designed lifts come with ARD feature assuring a completely stuck-free ride even during unexpected power failures.



#### Biobin and STP

The waste management is segregated into two different units, biobin and STP. The biobin units are for solid waste management and STP units for liquid waste treatment.



#### Children's play area

Amidst all serious amenities, an area is dedicated exclusively for children's play, arranged with rust-free play equipments guaranteeing your children real fun and more protection.



#### Premium fittings

Gratify your thoughts by entering a living space adorned with superior fittings and wash rooms with decorative paints, ceramic tiles and trendy mirror works.

### The Stairway to Green

Vegetable & Herbal garden in terrace

Rain water harvesting

Organic waste management

Solar power to grid

Waste water recycling

### Other amenities

Elegantly furnished designer theme lobby

Control room

Barbeque area

Health club with equipments

Ground water replenishment

24/7 generator power backup

Surrounding compound wall with security cabinet

Rubber fender in parking area

Name board and letter box

Anti termite treatment

Designated parking area for guests

CIVAANTA A Vishraam Project

